

NOTES TO USERS

This map is for use in administering the National Flood Insurance Program. It does not necessarily identify all areas subject to flooding, particularly from local drainage sources of small size. The community map repository should be consulted for possible updated or additional flood hazard information.

To obtain more detailed information in areas where **Base Flood Elevations (BFEs)** and/or **floodways** have been determined, users are encouraged to consult the Flood Profiles and Floodway Data and/or Summary of Stillwater Elevations tables contained within the Flood Insurance Study (FIS) report that accompanies this FIRM. Users should be aware that BFEs shown on the FIRM represent rounded whole-foot elevations. These BFEs are intended for flood insurance rating purposes only and should not be used as the sole source of flood elevation information. Accordingly, flood elevation data presented in the FIS report should be utilized in conjunction with the FIRM for purposes of construction and/or floodplain management.

Coastal Base Flood Elevations shown on this map apply only to landward of 0.0' National Geodetic Vertical Datum of 1929 (NGVD 29). Users of this FIRM should be aware that coastal flood elevations are also provided in the Summary of Stillwater Elevations table in the Flood Insurance Study report for this jurisdiction. Elevations shown in the Summary of Stillwater Elevations table should be used for construction and/or floodplain management purposes when they are higher than the elevations shown on this FIRM.

Boundaries of the **floodways** were computed at cross sections and interpolated between cross sections. The floodways were based on hydraulic considerations with regard to requirements of the National Flood Insurance Program. Floodway widths and other pertinent floodway data are provided in the Flood Insurance Study report for this jurisdiction.

Certain areas not in Special Flood Hazard Areas may be protected by **flood control structures**. Refer to Section 2.4 "Flood Protection Measures" of the Flood Insurance Study report for information on flood control structures for this jurisdiction.

The **projection** used in the preparation of this map was Universal Transverse Mercator (UTM) zone 10. The **horizontal datum** was NAD83, GRS1980 spheroid. Differences in datum, spheroid, projection or UTM zones used in the production of FIRMs for adjacent jurisdictions may result in slight positional differences in map features across jurisdiction boundaries. These differences do not affect the accuracy of this FIRM.

Flood elevations on this map are referenced to the National Geodetic Vertical Datum of 1929. These flood elevations must be compared to structure and ground elevations referenced to the same **vertical datum**. For information regarding conversion between the National Geodetic Vertical Datum of 1929 and the North American Vertical Datum of 1988, visit the National Geodetic Survey website at <http://www.ngs.noaa.gov/> or contact the National Geodetic Survey at the following address:

NGS Information Services
NOAA, NNGS12
National Geodetic Survey
SSMC-3, #9202
1315 East-West Highway
Silver Spring, MD 20910-3282

To obtain current elevation, description, and/or location information for **bench marks** shown on this map, please contact the Information Services Branch of the National Geodetic Survey at (301) 713-3242, or visit its website at <http://www.ngs.noaa.gov/>.

Base map information shown on this FIRM was provided in digital format by the USDA National Agriculture Imagery Program (NAIP). This information was photogrammetrically compiled at a scale of 1:24,000 from aerial photography dated 2012.

This map may reflect more detailed or up to date stream channel configurations than those shown on the previous FIRM. The floodplains and floodways that were transferred from the previous FIRM may have been adjusted to conform to these new stream channel configurations and improved topographic data. The profile baselines depicted on this map represent the hydraulic modeling baselines that match the flood profiles and Floodway Data Tables if applicable, in the FIS report. As a result, the profile baselines may deviate significantly from the new base map channel representation and may appear outside of the floodplain.

Corporate limits shown on this map are based on the best data available at the time of publication. Because changes due to annexations or de-annexations may have occurred after this map was published, map users should contact appropriate community officials to verify current corporate limit locations.

Please refer to the separately printed **Map Index** for an overview map showing the layout of map panels for this jurisdiction.

For information and questions about this map, available products associated with this FIRM including historic versions of this FIRM, how to order products or the National Flood Insurance Program in general, please call the FEMA Map Information eXchange at 1-877-FEMA-MAP (1-877-336-2627) or visit the **FEMA Map Service Center** website at <http://msc.fema.gov>. Available products may include previously issued Letters of Map Change, a Flood Insurance Study Report, and/or digital versions of this map. Many of these products can be ordered or obtained directly from the website. Users may determine the current map date for each FIRM panel by visiting the **FEMA Map Service Center** website or by calling the FEMA Map Information eXchange.

SECLUSION NOTE:

ATTENTION: THE LEVEES, DIKES, OR OTHER STRUCTURES INSIDE THIS BOUNDARY HAVE NOT BEEN SHOWN TO COMPLY WITH SECTION 65.10 OF THE NFIP REGULATIONS. AS SUCH, THIS FIRM PANEL WILL BE REVISED AT A LATER DATE TO UPDATE THE FLOOD HAZARD INFORMATION ASSOCIATED WITH THESE STRUCTURES. THE FLOOD HAZARD DATA SHOWN INSIDE THIS BOUNDARY (WHICH HAVE BEEN RE-PUBLISHED FROM THE DECEMBER 2, 2008 FIRM FOR SUTTER COUNTY, CALIFORNIA), SHOULD CONTINUE TO BE USED UNTIL THIS FIRM PANEL IS REVISED TO UPDATE THE FLOOD HAZARD INFORMATION IN THIS AREA.

----- Seclusion Area boundary

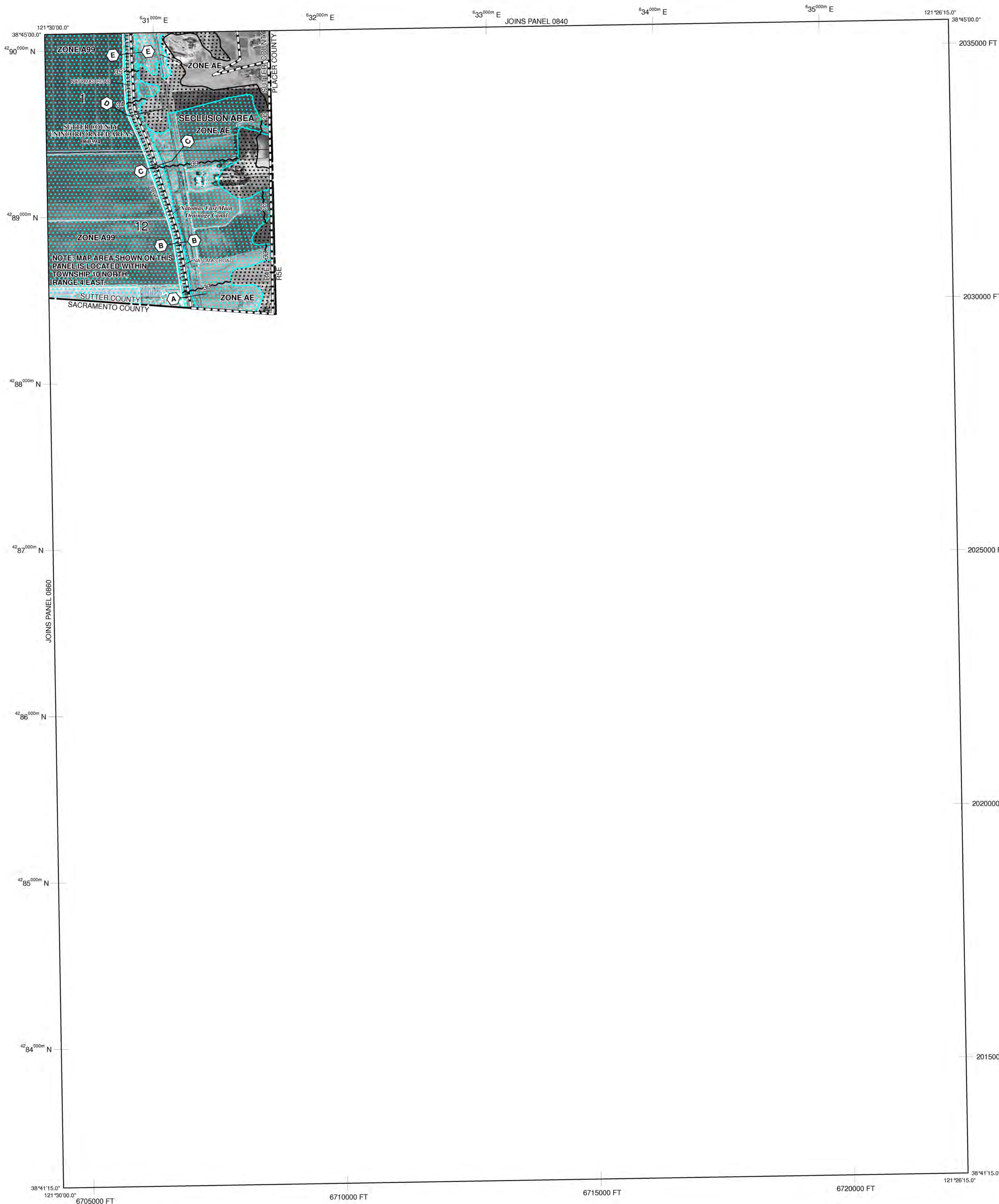

LEGEND

- SPECIAL FLOOD HAZARD AREAS (SFHAs) SUBJECT TO INUNDATION BY THE 1% ANNUAL CHANCE FLOOD**
- The 1% annual chance flood (100-year flood), also known as the base flood, is the flood that has a 1% chance of being equaled or exceeded in any given year. The Special Flood Hazard Area is the area subject to flooding by the 1% annual chance flood. Areas of Special Flood Hazard include Zones A, AE, AH, AO, AR, A99, V and VE. The Base Flood Elevation is the water-surface elevation of the 1% annual chance flood.
- ZONE A**: No Base Flood Elevations determined.
 - ZONE AE**: Base Flood Elevations determined.
 - ZONE AH**: Flood depths of 1 to 3 feet (usually areas of ponding); Base Flood Elevations determined.
 - ZONE AO**: Flood depths of 1 to 3 feet (usually sheet flow on sloping terrain); average depths determined. For areas of alluvial fan flooding, velocities also determined.
 - ZONE AR**: Special Flood Hazard Area formerly protected from the 1% annual chance flood by a flood control system that was subsequently decertified. Zone AR indicates that the former flood control system is being restored to provide protection from the 1% annual chance or greater flood.
 - ZONE A99**: Area to be protected from 1% annual chance flood by a Federal flood protection system under construction; no Base Flood Elevations determined.
 - ZONE V**: Coastal flood zone with velocity hazard (wave action); no Base Flood Elevations determined.
 - ZONE VE**: Coastal flood zone with velocity hazard (wave action); Base Flood Elevations determined.
- FLOODWAY AREAS IN ZONE AE**
- The floodway is the channel of a stream plus any adjacent floodplain areas that must be kept free of encroachment so that the 1% annual chance flood can be carried without substantial increases in flood heights.
- OTHER FLOOD AREAS**
- ZONE X**: Areas of 0.2% annual chance flood; areas of 1% annual chance flood with average depths of less than 1 foot or with drainage areas less than 1 square mile; and areas protected by levees from 1% annual chance flood.
- OTHER AREAS**
- ZONE X**: Areas determined to be outside the 0.2% annual chance floodplain.
 - ZONE D**: Areas in which flood hazards are undetermined, but possible.
- COASTAL BARRIER RESOURCES SYSTEM (CBRS) AREAS**
- OTHERWISE PROTECTED AREAS (OPAs)**
- CBRS areas and OPAs are normally located within or adjacent to Special Flood Hazard Areas.
- 1% annual chance floodplain boundary
 - 0.2% annual chance floodplain boundary
 - Floodway boundary
 - Zone D boundary
 - CBRS and OPA boundary
 - Boundary dividing Special Flood Hazard Areas of different Base Flood Elevations, flood depths or flood velocities.
 - Base Flood Elevation line and value; elevation in feet*
 - Base Flood Elevation value where uniform within zone; elevation in feet*
- * Referenced to the National Geodetic Vertical Datum of 1929 (NGVD 29)
- Cross section line
 - Transect line
 - Geographic coordinates referenced to the North American Datum of 1983 (NAD 83)
 - 1000-meter Universal Transverse Mercator grid ticks, zone 10
 - 5000-foot grid ticks: California State Plane coordinate system, II zone (FIPSZONE 0402), Lambert Conformal Conic
 - Bench mark (see explanation in Notes to Users section of this FIRM panel)
 - River Mile
- MAP REPOSITORY**
Sutter County Water Resources Division, 1130 Civic Center Blvd, Suite F, Yuba City, California 95993 (Maps available for reference only, not for distribution.)
- INITIAL NFIP MAP DATE**
June 7, 1977
- FLOOD HAZARD BOUNDARY MAP REVISIONS**
April 5, 1988
- FLOOD INSURANCE RATE MAP EFFECTIVE**
November 15, 1989 July 6, 1998 December 2, 2008
- June 16, 2015 - to change zone designations.
- To determine if flood insurance is available in this community, contact your insurance agent or call the National Flood Insurance Program at 1-800-638-6620.

NFIP

PANEL 0880F

FIRM
FLOOD INSURANCE RATE MAP

SUTTER COUNTY, CALIFORNIA
(UNINCORPORATED AREAS)

PANEL 880 OF 880
(SEE MAP INDEX FOR FIRM PANEL LAYOUT)

CONTAINS:

COMMUNITY	NUMBER	PANEL	SUFFIX
SUTTER COUNTY	060394	0880	F

Notes to User: The **Map Number** shown below should be used when placing map orders. The **Community Number** shown above should be used on insurance applications for the subject community.

MAP NUMBER
0603940880F

MAP REVISED
JUNE 16, 2015

Federal Emergency Management Agency